

Refrigerated-Dry Combo Display Case

Drop-In

SPECIFICATIONS

- Tempered, curved front glass (hinged and removable)
- Tempered glass sides (removable)
- Welded stainless steel construction
- Black laminate finish (custom colours available)
- Sliding glass doors on operator side
- 3/8" (10mm) thick tempered glass shelves
- Self-contained refrigeration system
- 6 ft (1829mm) long, 120volt, 5-15P cord and plug
- Front glass defogging system

OPTIONS (SPECIFY WHEN ORDERING)

- Shelf lights
- Custom laminate colours and finishes
- Remote refrigeration system

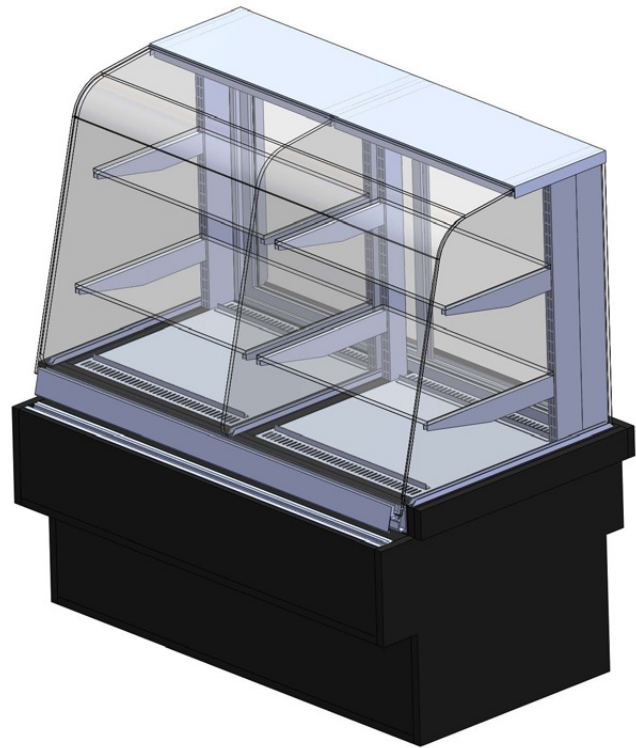
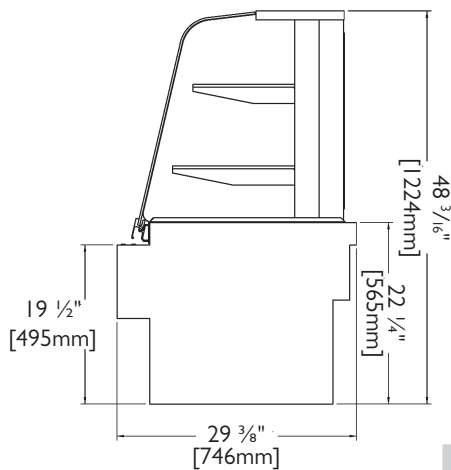

Operating temperature of 2° to 4° C (37° to 40° F) with an atmospheric temperature of 24° C (75° F) and relative humidity of 50%.

Items entering the case should be at or below 4° C (40° F).

Higher temperatures and/or humidity levels may result in condensation on the glass.

MODEL	DIMENSIONS (L x D x H*)	COMP. SIZE	ELECTRICAL DATA
CMBD38	38" x 29 ³ / ₈ " x 25 ¹⁵ / ₁₆ " (965mm x 746mm x 659mm)	¼ H.P.	115 V, 60Hz, 9 A
CMBD46	46" x 29 ³ / ₈ " x 25 ¹⁵ / ₁₆ " (1168mm x 746mm x 659mm)	¼ H.P.	115 V, 60Hz, 9 A
CMBD58	58" x 29 ³ / ₈ " x 25 ¹⁵ / ₁₆ " (1473mm x 746mm x 659mm)	¼ H.P.	115 V, 60Hz, 9 A
CMBD76	76" x 29 ³ / ₈ " x 25 ¹⁵ / ₁₆ " (1930mm x 746mm x 659mm)	½ H.P.	115 V, 60Hz, 10 A
CMBD92	92" x 29 ³ / ₈ " x 25 ¹⁵ / ₁₆ " (2337mm x 746mm x 659mm)	½ H.P.	115 V, 60Hz, 10 A

*Height from drop-in surface to top of case.

CUSTOM CONFIGURATIONS ARE AVAILABLE FOR ALL OF OUR PRODUCTS. CONTACT US FOR DETAILS.

JAKSER

8052 Torbram Road
 Brampton, Ontario
 Canada, L6T 3T2

T: 905-791-2914
 F: 905-791-2919
 E: sales@jakser.com

Proudly Canadian



JAKSER.com

DC-CMBD v1.0